

CALL THE WORKING DAVIS
BEFORE YOU DIG
602-263-1100
1-800-STAKE-17
(OUTSIDE MARICOPA COUNTY)

NOTES TO CONTRACTOR:
1) CONTRACTOR TO FIELD VERIFY ALL EXISTING DEPICTED AND OBTAIN ALL NECESSARY PERMITS FROM THE APPLICABLE AGENCIES. THE CONTRACTOR SHALL BE RESPONSIBLE FOR OBTAINING ALL NECESSARY PERMITS FROM THE APPLICABLE AGENCIES. THE CONTRACTOR SHALL BE RESPONSIBLE FOR OBTAINING ALL NECESSARY PERMITS FROM THE APPLICABLE AGENCIES. THE CONTRACTOR SHALL BE RESPONSIBLE FOR OBTAINING ALL NECESSARY PERMITS FROM THE APPLICABLE AGENCIES.

- CONSTRUCTION NOTES:
- 1) CONC. WATER AND SANITARY SEWER PROTECTION SEE WAD STANDARD DETAIL 4-01
 - 2) INSTALL SEE AND THURST BLOCK SEE WAD STANDARD DETAIL 380
 - 3) CONST. FINE HORIZONTAL SEE WAD STANDARD DETAIL 380
 - 4) 8" OIL WATERLINE SHALL INCLUDE CLUB STOP AND RUSH PIPE. SEE WAD STANDARD DETAIL 4-01
 - 5) WAD VALVE TAPPING, SECTORS AND WAD VALVE SEE WAD STD DET 5-05.

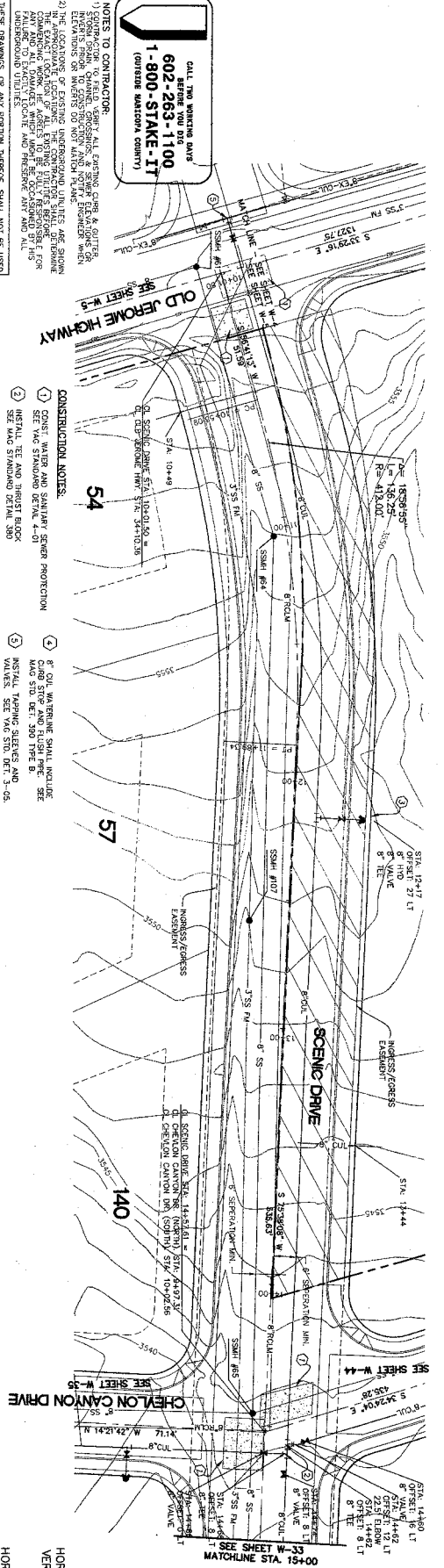

(24"x36")
HORIZONTAL 1" = 20'
VERTICAL 1" = 5'
(11"x17")
HORIZONTAL 1" = 40'
VERTICAL 1" = 10'

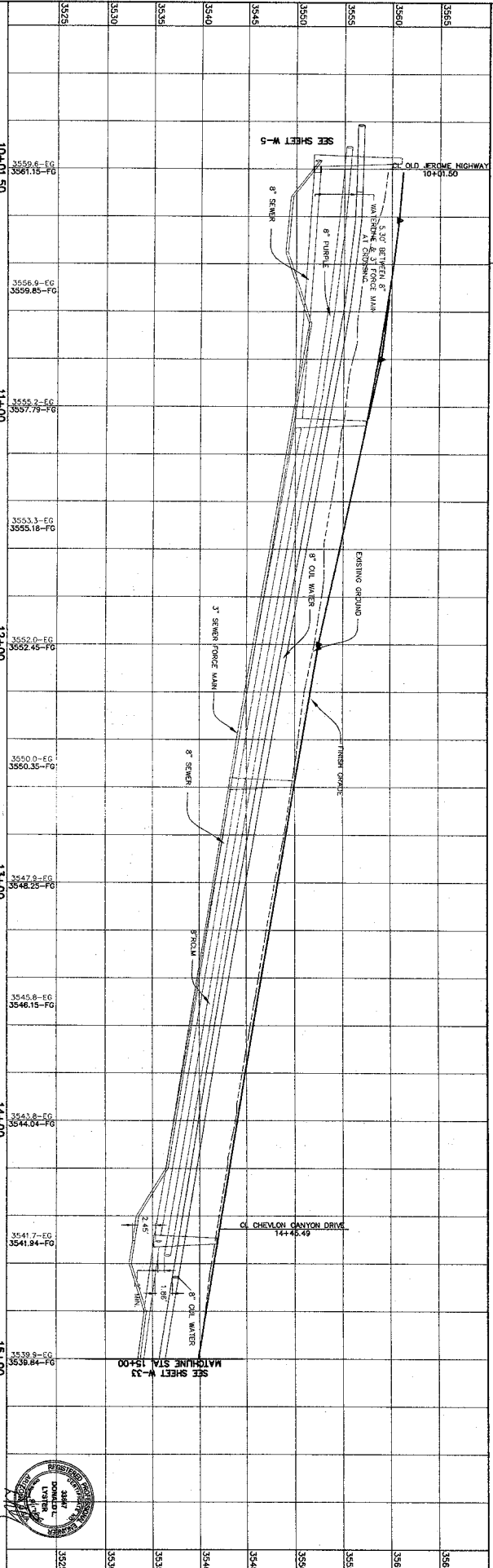

STATION	CONSTRUCTION	DATE	BY	CHECKED	DATE
3525	10+01.50				
3530	11+00				
3535	12+00				
3540	13+00				
3545	14+00				
3550	15+00				



Northern Engineering Inc
ENGINEERING-LAND PLANNING
CONSTRUCTION MANAGEMENT
1040 E. 800 N.
OPEN, UTAH 84097
(801) 802-8992

THE HIGHLANDS

SCENIC DRIVE STA. 10+01.50- 15+00
WATER PLAN & PROFILE

JOB NO. 3-05-030-00
SHEET NO. W-32